

# ALTO<sup>®</sup>

CLARKE  
TECHNOLOGY

**Operator's  
Manual**

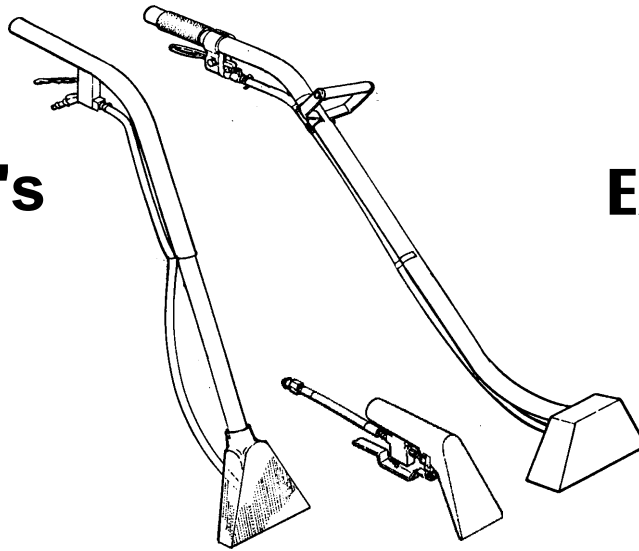

**Extractor  
Tools**

## **READ THIS BOOK**

This book has important information for the use and safe operation of this machine. Failure to read this book prior to operating or attempting any service or maintenance procedure to your ALTO machine could result in injury to you or to other personnel; damage to the machine or to other property could occur as well. You must have training in the operation of this machine before using it. If you cannot read English, have this manual explained fully before attempting to operate this machine.

All directions given in this book are as seen from the operator's position at the rear of the machine.

For new books write to: ALTO U.S. Inc., 2100 Highway 265, Springdale, Arkansas 72764.

## CONTENTS OF THIS BOOK

|  |    |
|--|----|
| Operator Safety Instructions .....                         | 3  |
| Introduction .....   | 4  |
| How to Operate the 4" Floor Tool .....                     | 4  |
| How to Operate the 8" and 12" Floor Tool .....             | 5  |
| How to Clean the Carpet .....                              | 6  |
| Maintenance .....  | 7  |
| 4" Plastic Hand Tool Assembly Drawing and Parts List ..... | 8  |
| 4" Metal Hand Tool Assembly Drawing & Parts List .....     | 9  |
| 8" Plastic Wand Assembly Drawing & Parts List .....        | 10 |
| 12" Metal Wand Assembly Drawing & Parts List .....         | 11 |

## OPERATOR SAFETY INSTRUCTIONS



**WARNING**



**AVERTISSEMENT**



**ADVERTENCIA**

For the safe operation of these tools, read and understand all warnings and cautions.



**DANGER** means: Severe bodily injury or death can occur to you or other personnel if the **DANGER** statements found on your machine or in your Owner's Manual are ignored or are not adhered to. Read and observe all **DANGER** statements found in your Owner's Manual and on your machine.



**WARNING** means: Injury can occur to you or to other personnel if the **WARNING** statements found on your machine or in your Owner's Manual are ignored or are not adhered to. Read and observe all **WARNING** statements found in your Owner's Manual and on your machine.



**CAUTION** means: Damage can occur to the machine or to other property if the **CAUTION** statements found on your machine or in your Owner's Manual are ignored or not adhered to. Read and observe all **CAUTION** statements found in your Owner's Manual and on your machine.



**DANGER:** Tools can cause an explosion when operated near flammable materials and vapors. Do not use these tools with or near fuels, grain dust, solvents, thinners, or other flammable materials.



**WARNING:** You must have training in the operation of these tools before using them. **READ THE INSTRUCTION BOOK FIRST.**



**WARNING:** Do not use this tool as a step or furniture.



**WARNING:** Maintenance and repairs must be done by authorized personnel only.



**WARNING:** Keep all fasteners tight. Keep the adjustments according to specifications.



**WARNING:** Make sure that all the labels, decals, warnings, cautions and instructions are fastened to the tool. Replace them when necessary by ordering them from Clarke Technology.



**WARNING:** Do not use water that is hotter than 140°F.



**NOTICE:** For safety, **READ** and **OBEY** the **INSTRUCTIONS** given in the Owner's Manual for the extractor that is used with these tools.

---

## INTRODUCTION

The extractor tools are tools for cleaning the carpet. When used with an extractor, the tools apply cleaning solution to the carpet, and removes dirty solution and soil from the carpet.

- Use the 4" metal and 4" plastic hand tools to clean stairs and small areas of carpet. These tools clean a path 3½ inches wide.
- Use the 8" plastic wand and 12" metal wand to clean edges of a room and larger areas of carpet. The 8" wand cleans a path 8 inches wide. The 12" wand cleans a path 12 inches wide.
- The extractor has controls to start the pump for the solution and the motor for the vacuum. The floor tool has a control to release the solution.

---

## How To Operate The 4" Hand Tools

**NOTE:** Instructions for preparation and operation of your extractor are given with the extractor.

 **CAUTION:** Clarke Technology will not be held liable for damage to the carpet, or poor results because of operator's lack of training.

To operate the 4" hand tools, follow this procedure:

1. Connect the vacuum hose to the hose connector on the extractor and to the end of the vacuum tube on the floor tool.
2. Connect the solution hose to the extractor and the floor tool. To fasten the quick-disconnect, slide the knurled collar on the female coupling away from the opening. Push the male coupling into the female coupling.
3. The switch that activates the motor for the pump is on the extractor. Put the switch in the "ON" position.
4. The switch that activates the motor for the vacuum is on the extractor. Put the switch in the "ON" position.
5. Begin at the right-hand corner of the area to be cleaned.
6. Press the solution release lever. Pull the tool toward you at a slow steady speed.

---

## How To Operate The 8" and 12" Wands

**NOTE:** Instructions for preparation and operation of your extractor are given with the extractor.

 **CAUTION:** Clarke Technology will not be held liable for damage to the carpet, or poor results because of operator's lack of training.

 **CAUTION:** Do not use water that is hotter than 140°F.

To operate the 8" and 12" wands follow this procedure:

1. Connect the vacuum hose to the hose connector on the extractor and to the end of the vacuum tube on the floor.
2. Connect the solution hose to the extractor and the floor tool. To fasten the quick-disconnect slide the knurled collar on the female coupling away from the opening. Push the male coupling into the female coupling.
3. The switch that activates the motor for the pump is on the extractor. Put the switch in the "ON" position.
4. The switch that activates the motor for the vacuum is on the extractor. Put the switch in the "ON" position.
5. Move the floor tool to the right-hand corner of the carpet.
6. Hold the floor tool at an angle that gives the best seal between the tool to increase the seal.
7. Press down on the tool to increase the seal.
8. Press the solution release lever.
9. Move backwards and pull the tool toward you at a rate of about 30 feet per minute. Move slower for very dirty areas.
10. Release the solution lever approximately six inches before you stop moving backward.
11. Lift the wand and move it to the side of the starting point.
12. To clean the edge of a room, move the wand along the baseboard.

---

## How To Clean The Carpet

 **WARNING:** When using the tools and the extractor to clean, make sure this procedure is followed.

1. Do not walk on freshly cleaned carpet for at least four hours or until the carpet is dry to the touch.
2. Do not remove aluminum or plastic pieces that have been placed under the legs of the furniture until the carpet is dry.
3. Do not allow children or pets to crawl or walk around on the damp carpet.

### **How To Clean A Small Area Of Carpet**

To clean a small area of carpet, follow this procedure:

1. Clean the carpet in sections of three feet square.
2. As you make a pass, repeat one inch of the area already cleaned.
3. To remove more liquid from the carpet, make passes over the area already cleaned. Do not press the solution lever.

### **How To Clean A Large Area Of Carpet**

To clean a large area of carpet follow this procedure:

1. Begin at the right-hand corner of the carpet.
2. Make a pass halfway along the edge of the carpet. Pull the tool back at a steady speed.
3. Move to the edge of the carpet. Make another pass next to your first pass.
4. As you make more passes, repeat one inch of the area already cleaned. Make each pass four inches different in length to prevent making a line in the center of the carpet.
5. Make more passes until half of the carpet is cleaned.
6. Move to the right-hand corner of the part of the carpet not yet to be cleaned.
7. Make a pass halfway along the edge of the carpet.
8. As you make more passes, repeat one inch of the area already cleaned.
9. Make more passes until all of the room is cleaned.

---

|                    |
|--------------------|
| <b>MAINTENANCE</b> |
|--------------------|

After each use of the tools, do the following:

1. Use clean water from the extractor to flush the solution system of each of the tools.
2. Disconnect the solution hose and the vacuum hose from the machine.
3. To drain the solution system, press the pin in the male connector for the solution hose. Press the solution release lever.
4. Check for objects in the vacuum opening. Use a stick to remove any objects from the vacuum opening.
5. Check for leaks at all connections.
6. Apply a small amount of silicone lubricant to the quick-disconnect fittings. To prevent damage to the O-rings, do not use an oil lubricant.
7. Check the spray jets on the floor tools. If a spray jet is not working correctly, use this procedure to clean the jet:
  - a. Remove the jet from the machine and put it in a solution of ammonia and water.
  - b. Blow compressed air through the jet and install the jet on the tool.

 **CAUTION: To prevent damage to the spray jet, do not push a wire or any object through the opening in the jet.**

8. Use a dry cloth to wipe the tool.

**CLARKE TECHNOLOGY 4" Plastic Hand Tool**  
**Tool Asm. 11/97**  
**59231A**

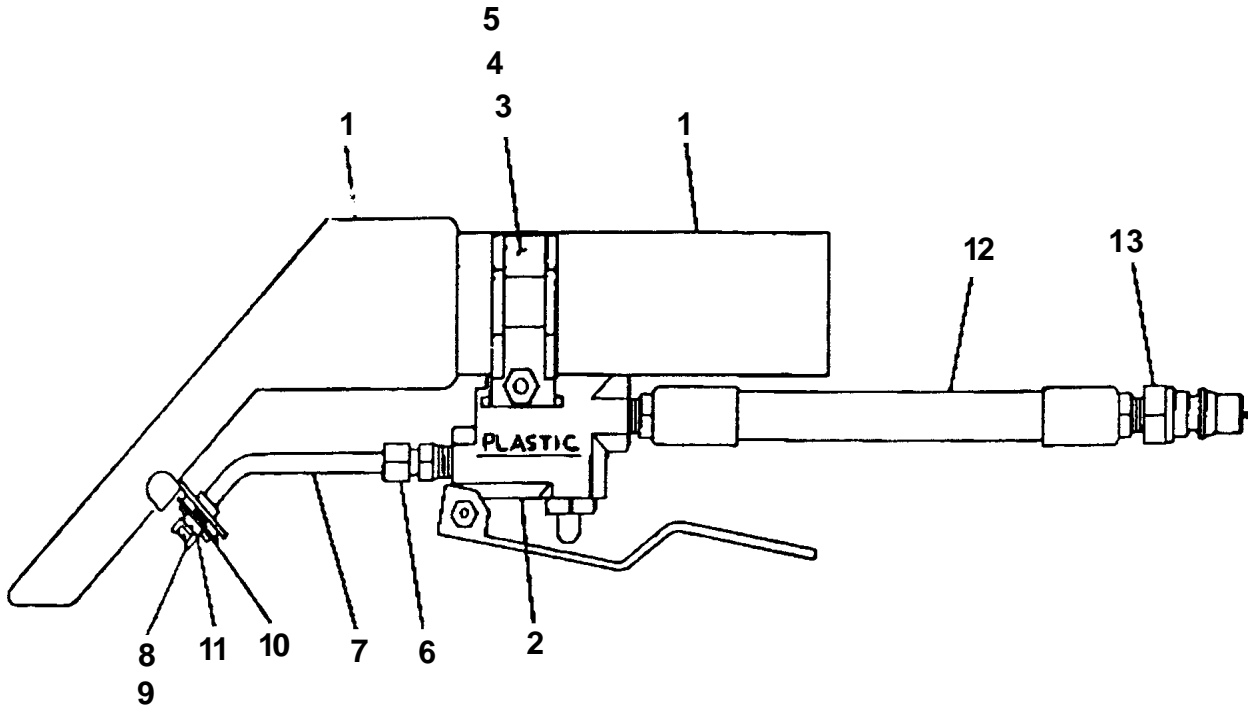

| Ref # | Part No. | Description                         | Qty. |
|-------|----------|-------------------------------------|------|
| 1     | 55179A   | Plastic Head w/tube 1½"             | 1    |
| 2     | 59618A   | Valve Assembly, Plastic             | 1    |
| 3     | 55181A   | VS Valve Hanger 1½"                 | 2    |
| 4     | 85611A   | Screw, S.S. Pan Hd 10-32 x 1¼"      | 1    |
| 5     | 92022A   | Nut, S.S. Hex 10-32                 | 1    |
| 6     | 54060A   | Tube Comp., 1/8 MPT x 3/16" Ferrule | 1    |
| 7     | 56123A   | Manifold                            | 1    |
| 8     | 54177A   | Tee Jet, Plastic Orange             | 1    |
| 9     | 56508A   | O-Ring, 7/16" O.D. x 5/16" I.D.     | 1    |
| 10    | 57011A   | Retainer Plate                      | 1    |
| 11    | 962802   | Screw, 8-32 x ¼" S.S. Fillister Hd. | 2    |
| 12    | 55180A   | Hose Assembly, Solution             | 1    |
| 13    | 737140   | Quick Connector, 1/8 FPT Male       | 1    |



**CLARKE TECHNOLOGY 4" Metal Hand Tool**  
**Tool Asm. 11/97**  
**59228A**

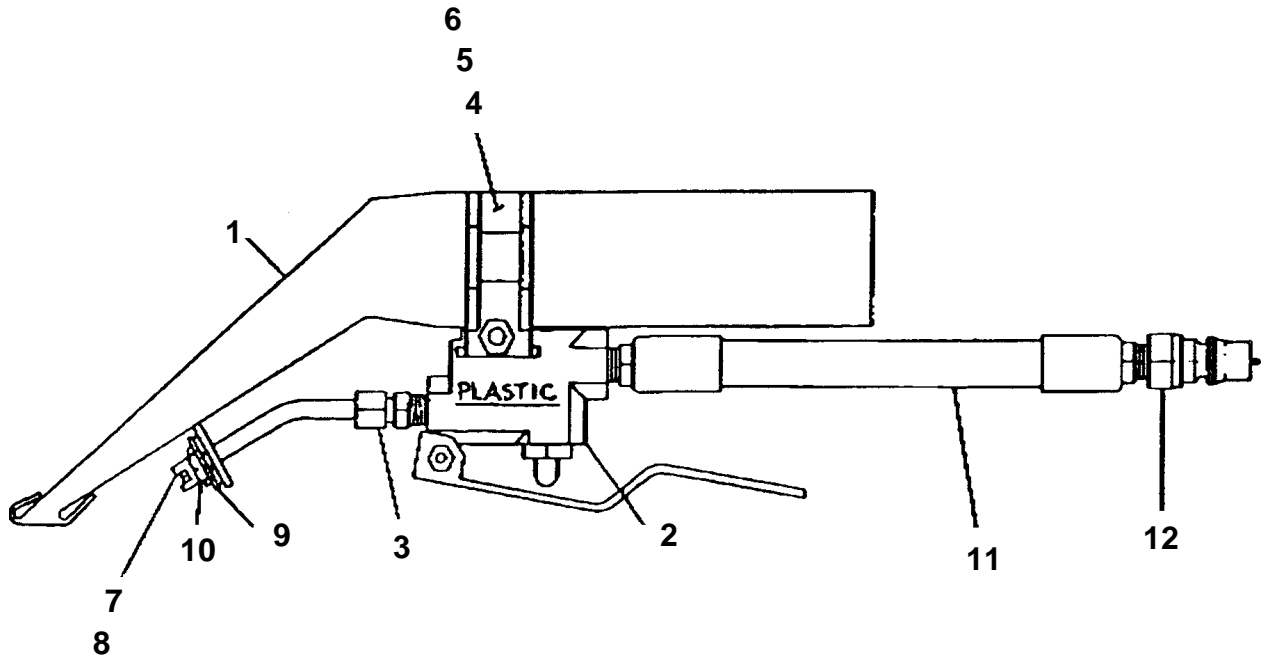

| Ref # | Part No. | Description                         | Qty. |
|-------|----------|-------------------------------------|------|
| 1     | 55175A   | Head Assembly                       | 1    |
| 2     | 59618A   | Valve Assembly, Plastic             | 1    |
| 3     | 54060A   | Tube Comp., 1/8 MPT x 3/16" Ferrule | 1    |
| 4     | 55181A   | VS Valve Hanger 1 1/2               | 2    |
| 5     | 85611A   | Screw, S.S. Pan Hd 10-32 x 1 1/4"   | 1    |
| 6     | 92022A   | Nut, S.S. Hex 10-32                 | 1    |
| 7     | 54177A   | Tee Jet                             | 1    |
| 8     | 56507A   | O-Ring, 3/8 O.D. x 1/4 I.D.         | 1    |
| 9     | 57011A   | Retainer Plate                      | 1    |
| 10    | 962802   | Screw, 8-32 x 1/4" Fillister Hd.    | 2    |
| 11    | 55180A   | Hose Assembly, Solution             | 1    |
| 12    | 737140   | Quick Conn., 1/8 FPT Male           | 1    |

**CLARKE TECHNOLOGY 8" Plastic Wand**  
**Tool Asm. 4/99**  
**59230A**

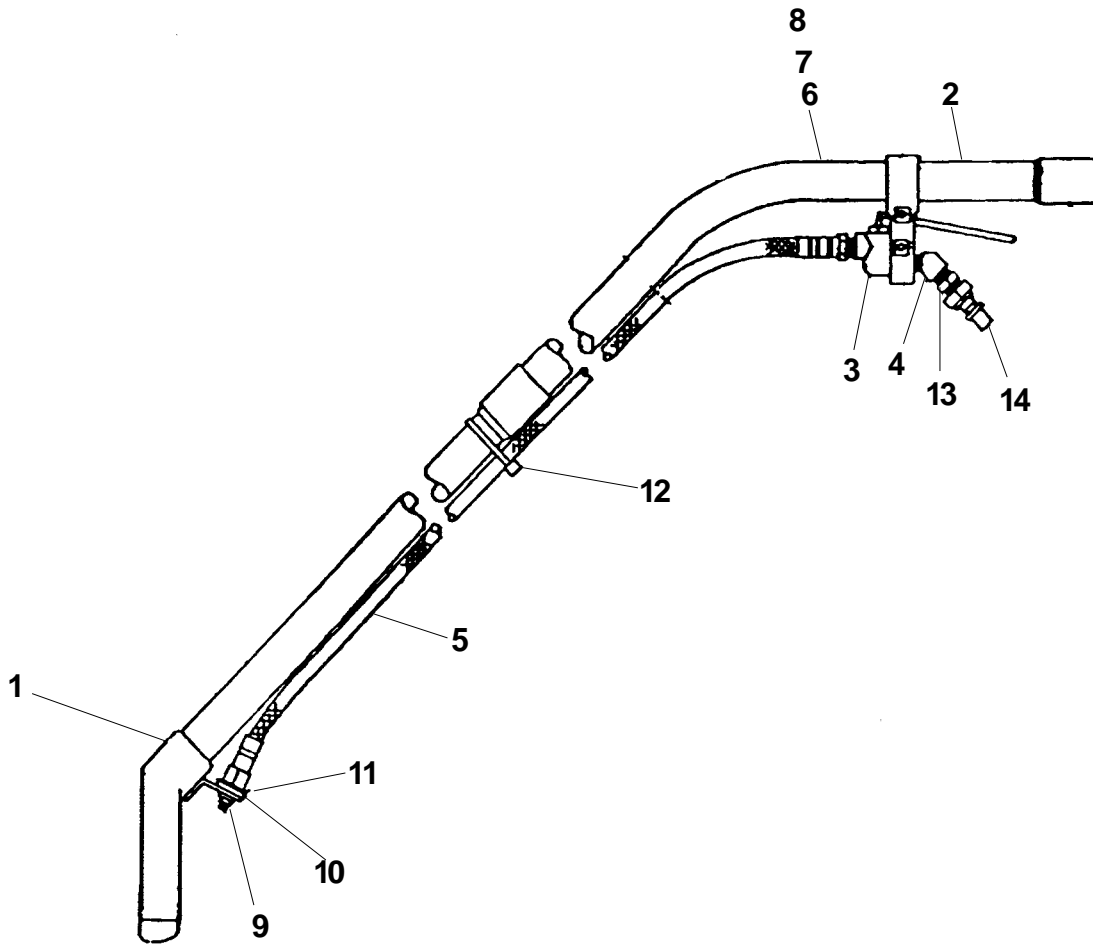

**NOTE:** u indicates a change has taken place since last publication of this manual.

| Ref # | Part No.        | Description                     | Qty. |
|-------|-----------------|---------------------------------|------|
| 1     | 50383A <u>u</u> | Head and Tube Assembly          | 1    |
| 2     | 59324A          | Upper Tube                      | 1    |
| 3     | 59616A          | Valve Assembly, Plastic         | 1    |
| 4     | 722124          | Elbow, 45° Street               | 1    |
| 5     | 30043A <u>u</u> | Hose, Solution 38"              | 1    |
| 6     | 55177A          | Valve Hanger, 1¼" Cast Aluminum | 2    |
| 7     | 85611A          | Screw, Pn Hd 10-32 x 1¼ S.S.    | 2    |
| 8     | 92022A          | Nut, S.S. Hex 10-32             | 2    |
| 9     | 30044A <u>u</u> | Nozzle, ¼ (2 x 80°)             | 1    |
| 10    | 80082A <u>u</u> | Washer, Plastic                 | 1    |
| 11    | 80083A <u>u</u> | Washer, Flat 9/16 SS            | 1    |
| 12    | 58901A          | Cable Tie, ¾" Black             | 1    |
| 13    | 687501          | Nipple, ¼ MPT x 1/8 MPT Hex     | 1    |
| 14    | 737140          | Quick Connector, 1/8 FPT Male   | 1    |

**CLARKE TECHNOLOGY 12" Metal Wand**  
**Tool Asm. 5/01**  
**59229A**

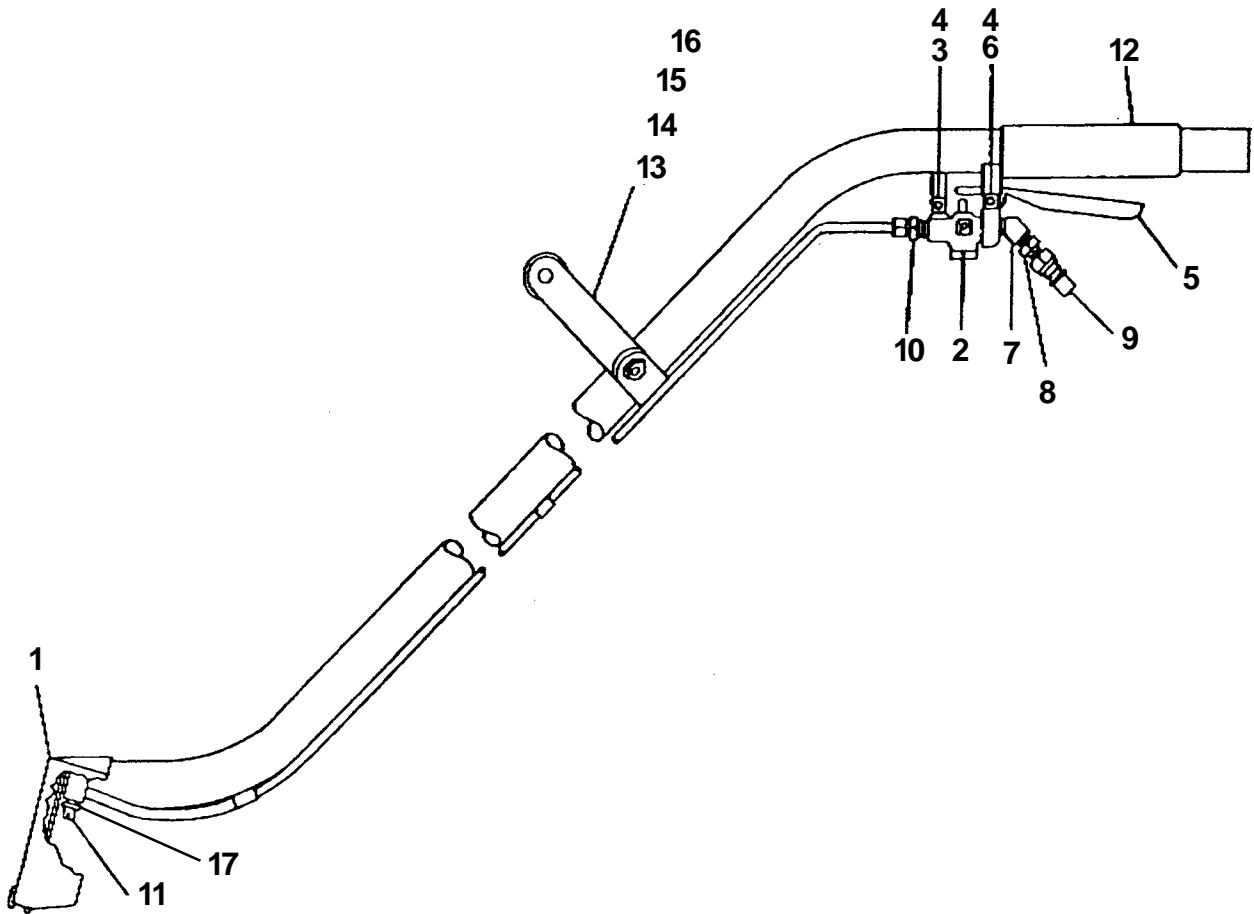

| Ref # | Part No. | Description                        | Qty. |
|-------|----------|------------------------------------|------|
| 1     | 59890A   | Wand Assembly                      | 1    |
| 2     | 59615A   | Valve Assembly                     | 1    |
| 3     | 85307a   | Screw, S.S. Pan Hd 10-32 x 5/8"    | 1    |
| 4     | 920722   | Nut, S.S. Nylock 10-32             | 2    |
| 5     | 55809a   | Lever Valve                        | 1    |
| 6     | 85611A   | Screw, S.S. Pan Hd. 10-32 x 1 1/8" | 1    |
| 7     | 722124   | Elbow, 45° Street                  | 1    |
| 8     | 697501   | Nipple, 1/4 MPT x 1/8 MPT Hex      | 1    |
| 9     | 737140   | Quick Connector, 1/8 FPT Male      | 1    |
| 10    | 54061A   | Tube Comp. Ferrule, 1/4 MPT x 1/4" | 1    |
| 11    | 54174A   | Vee Jet, 1/4 MPT Brass             | 2    |
| 12    | 54507A   | Grip, Vinyl 6" x 1 1/2" Dia.       | 1    |
| 13    | 54933A   | Handle Assembly                    | 1    |
| 14    | 54934A   | Handle Back                        | 1    |
| 15    | 962139   | Bolt, S.S. 1/4-20 x 5/8"           | 2    |
| 16    | 920208   | Nut, S.S. Hex 1/4-20               | 2    |
| 17    | 30184A   | Strainer, Spray Jet                | 2    |



# ALTO® PRODUCT SUPPORT BRANCHES

## U. S. A. Locations

### HEAD OFFICE

ALTO U.S. Inc., St. Louis, Missouri  
16253 Swingley Ridge Road, Suite 200  
Chesterfield, Missouri 63017-1725

### PRODUCTION FACILITIES

ALTO U.S. Inc., Springdale, Arkansas  
2100 Highway 265  
Springdale, Arkansas 72764  
(501) 750-1000

**Customer Service - 1-800-253-0367**

**Technical Service - 1-800-356-7274**

ALTO U.S. Inc., Bowling Green, Ohio 43402  
1100 Haskins

ALTO U.S. Inc., Clearwater, Florida 33765  
1500 N. Belcher Road

### SERVICE FACILITIES

ALTO U.S. Inc., Carlstadt, New Jersey 07072  
150 Commerce Road  
(201) 460-4774

ALTO U.S. Inc., Elk Grove, Illinois 60007  
2280 Elmhurst Road  
(847) 956-7900

ALTO U.S. Inc., Denver, Colorado 80204  
1955 West 13th Ave.  
(303) 623-4367

ALTO U.S. Inc., Houston, Texas 77040  
7215 North Gessner Road

### SALES AND SERVICE FACILITIES

ALTO U.S. Inc., Madison Heights, Michigan 48071-0158  
29815 John R.  
(810) 544-6300

ALTO U.S. Inc., Marietta, Georgia 30062  
1355 West Oak Common Lane  
(770) 973-5225

---

**CLARKE TECHNOLOGY  
AMERICAN SANDERS TECHNOLOGY  
A.L. COOK TECHNOLOGY  
Customer Service Headquarters and Factory**

2100 Highway 265  
Springdale, Arkansas 72764  
(501) 750-1000

**Technical Service  
1-800-356-7274**

## European Locations

### PRODUCTION FACILITIES

ALTO Danmark A/S, Aalborg  
Blytaekkervej 2  
DK-9000 Aalborg  
+45 72 18 21 00

ALTO Danmark A/S, Hadsund  
Industrikvarteret  
DK-9560 Hadsund  
+45 72 18 21 00

### SALES SUBSIDIARIES

ALTO Canada Ltd., Rexdale Ontario  
24 Constellation Ct.  
(416) 675-5830

ALTO Overseas Inc., Sydney (Australia)  
1B/8 Resolution Drive  
Caringbah NSW 2229  
+61 2 9524 6122

ALTO Cleaning Systems Asia Pte Ltd., Singapore  
No. 17 Link Road  
Singapore 619034  
+65 268 1006

ALTO Deutschland GmbH, Fronenberg (Germany)  
Ardeyer Str. 15  
D-58730 Fronenberg  
+49 2373 754 200

ALTO Cleaning Systems (UK) Ltd., Penrith  
Gilwilly Industrial Estate  
Penrith  
Cumbria CA11 9BN  
+44 1768 868 995

ALTO France S.A. Strasbourg  
B.P. 44, 4 Place d'Ostwald  
F-67036 Strasbourg  
Cedex 2  
+33 3 8828 8400

ALTO Nederland B.V. Vianen  
Stuartweg 4C  
NL-4131 NJ Vianen  
+31 347 324000

ALTO Sverige AB, Molndal (Sweden)  
Aminogatan 18  
Box 4029  
S-431 04 Molndal  
+46 31 706 73 00

ALTO Norge A/S, Oslo (Norway)  
Bjornerudveien 24  
N-1266  
+47 2275 1770

## CLARKE TECHNOLOGY WARRANTY

This Clarke Technology Industrial/Commercial Product is warranted to be free from defects in materials and workmanship under normal use and service for a period of one year from the date of purchase, when operated and maintained in accordance with Clarke Technology's Maintenance and Operations instructions.

This warranty is extended only to the original purchaser for use of the product. It does not cover normal wear parts such as electrical cable, rubber parts, hoses and motor brushes.

If difficulty develops with the product, you should:

- (a). Contact the nearest authorized Clarke Technology repair location or contact the Clarke Technology Service Operations Department, 2100 Highway 265, Springdale, Arkansas 72764, for the nearest authorized Clarke Technology repair location. Only these locations are authorized to make repairs to the product under this warranty.
- (b). Return the product to the nearest Clarke Technology repair location. Transportation charges to and from the repair location must be prepaid by the purchaser.
- (c). Clarke Technology will repair the product and or replace any defective parts without charge within a reasonable time after receipt of the product.

Clarke Technology's liability under this warranty is limited to repair of the product and/or replacement of parts and is given to purchaser in lieu of all other remedies, including INCIDENTAL AND CONSEQUENTIAL DAMAGES.

THERE ARE NO EXPRESS WARRANTIES OTHER THAN THOSE SPECIFIED HEREIN. THERE ARE NO WARRANTIES WHICH EXTEND BEYOND THE DESCRIPTION OF THE FACE HEREOF. NO WARRANTIES, INCLUDING BUT NOT LIMITED TO WARRANTY OF MERCHANTABILITY, SHALL BE IMPLIED. A warranty registration card is provided with your Clarke Technology product. Return the card to assist Clarke Technology in providing the performance you expect from your new floor machine.

ALTO U.S. INC., 2100 Highway 265, Springdale, Arkansas 72764.

**CLARKE TECHNOLOGY reserves the right to make changes  
or improvements to its machine without notice.**



**Always use genuine Clarke Technology Parts for repair.**



**2100 Highway 265  
Springdale, Arkansas, 72764**